

M12 connector RA  
(screw connections)  
7519020355 -  $\varnothing$ 4-6 mm cables  
7519020356 -  $\varnothing$ 6-8 mm cables

M12 connector straight  
(screw connections)  
7519020350 -  $\varnothing$ 4-6 mm cables  
7519020351 -  $\varnothing$ 6-8 mm cables

Cable, with straight connector  
7519020365 - 5 m, unshielded  
7519020366 - 10 m, unshielded  
7519020380 - 10 m, shielded flexible

Cable, with RA connector  
7519020375 - 5 m, unshielded  
7519020376 - 10 m, unshielded

Replaceable head with 0-8 cables  
TO BE ORDERED SEPERATELY, part numbers:  
3985000000 - dummy without cables  
3985000001 - 1 cable  
3985000002 - 2 cables  
3985000003 - 3 cables  
3985000004 - 4 cables  
3985000005 - 5 cables  
3985000006 - 6 cables  
3985000007 - 7 cables  
3985000008 - 8 cables

CMM Easy  
P/N 0985074000

Cables to charging tool  
cable length 2 m

Customers machine panel

External Control Kit CMM Easy  
P/N 3985000200

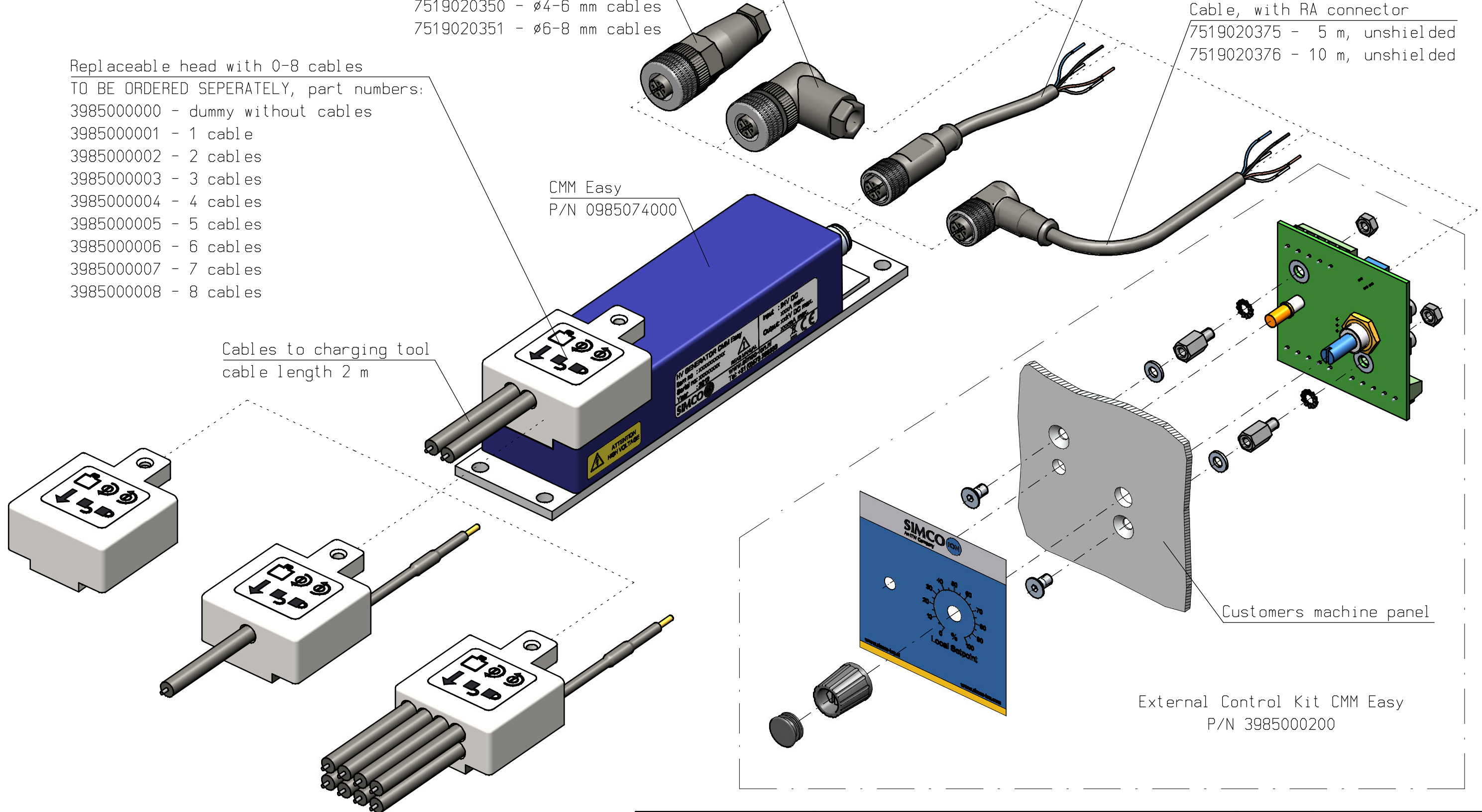

 An ITW Company	Name: CMM Easy overview (spare) parts					Drawn: AB	Part no.: —
	CAD generated NOT updated	Dimensions in mm	Date: 5-9-2012	A3	M: —	ECN2013-001	Check: BWB