

Zusatzschalldämpfer Additional silencer [mm]

2BX4 000
2BX4 010
2BX4 011
2BX4 013
2BX4 014
2BX4 015

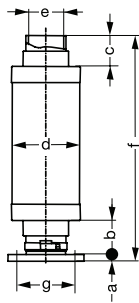

Ansicht X
View X

Ansicht X:
View X:

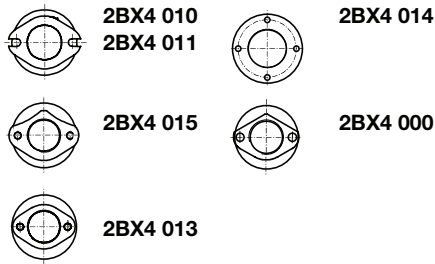

2BX4 012

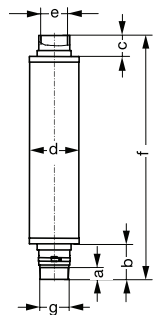

Typ • Type	a	b	c	d	e	f	g
2BX4 000	9	45	40	ø 83	ø 40,5	293	64
2BX4 010	9	45	40	ø 89	ø 50,5	294	72
2BX4 011	9	45	40	ø 75	ø 40,5	293	64
2BX4 012	32	65	56	ø 132	ø 80	651	G 2½
2BX4 013	22	75	60	ø 167	ø 115	658	150
2BX4 014	22	80	60	ø 209	ø 150	662	ø 210
2BX4 015	9	45	40	ø 88	ø 50,5	293	72

Zusatzschalldämpfer Additional Silencer [mm]

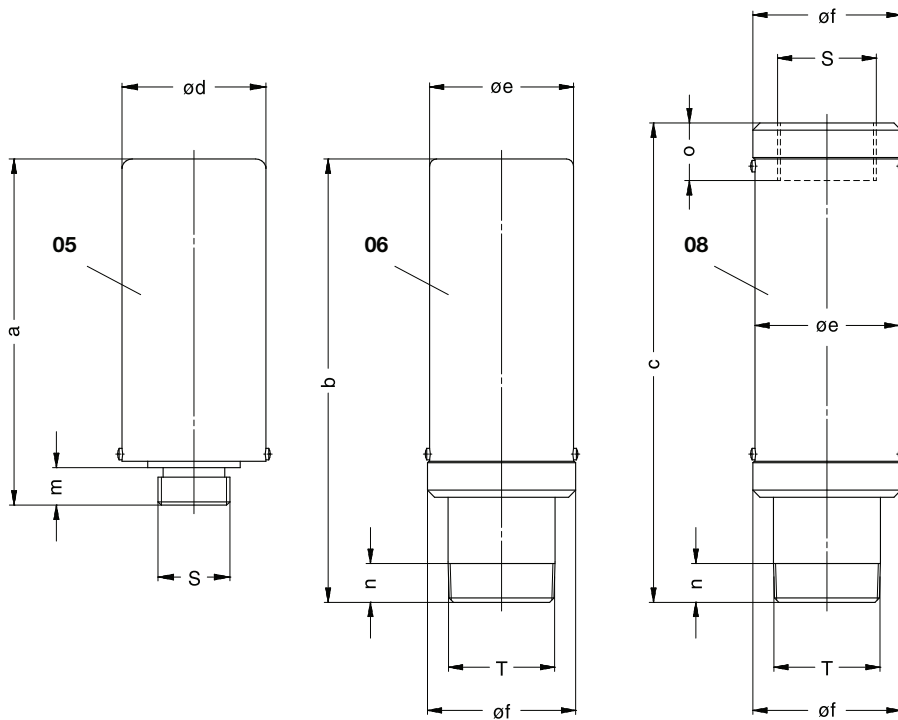

- 05** Ausführung mit Gewindenippel
Version with threaded nipple

- 06** Ausführung mit langem Gewindenippel
Version with barrel nipple

- 08** Ausführung mit beidseitigem Anschlussgewinde
Version with threaded connection at both ends

Typ • Type	a	b	c	ød	øe	øf	m	n	o	S	T
ZGD 32..	164	215	239	70	70	70	14	19	25	G 1¼	R 1¼
ZGD 40..	209	274	299	90	90	92	16	19	35	G ½	R 1½
ZGD 50..	209	289	314	90	90	92	16	24	35	G 2	R 2
ZGD 65..	231	308	333	102	102	105	16	27	35	G 2½	R 2½
ZGD 80..	265	349	384	112	112	115	16	30	45	G 3	R 3
ZGD 100..	265	451	414	112	142	145	11	36	45	G 4	R 4