

Ansaugfilter für G-BH1/G-BH7 Suction filter for G-BH1/G-BH7 [mm]

2BX2 104
2BX4 066

Ausf. • Model 01

Ausf. • Model 02

2BX2 100
2BX2 101
2BX2 102
2BX2 103
2BX2 107
2BX2 108

2BX4 061
2BX4 062
2BX4 063
2BX4 064
2BX4 065
2BX4 080

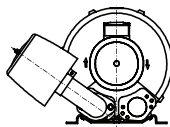
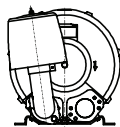
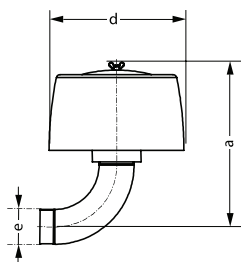

Typ • Type	Ausführung	a	b	c	d	e
	Model					
Für • For 2BH1						
2BX2 100 / 2BX4 062	01,02	257	95	45°	Ø132	64
2BX2 101 / 2BX4 061	01,02	300	179	45°	Ø168	75
2BX2 102 / 2BX4 064	01,02	295	130	55°	Ø168	85
	01	295	130	55°	Ø168	85
2BX2 103 / 2BX4 065	01	349	130	55°	Ø290	85
2BX2 104 / 2BX4 066	01	355	130	55°	Ø290	R2½
2BX2 107 / 2BX4 063	01	305	185	45°	Ø168	75
Für • For 2BH7						
2BX2 100	01	257	95	45°	Ø132	64
2BX2 108	01	305	185	45°	Ø168	64
2BX4 080	01	257	95	45°	Ø132	64

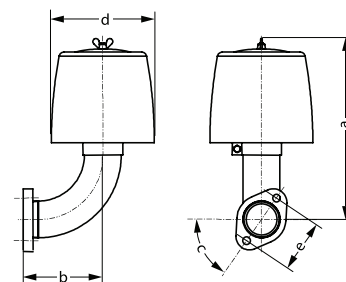

Ansaugfilter für G-BH2 VELOCIS Suction filter for G-BH2 VELOCIS [mm]

2BX4072
2BX4075
2BX4073
2BX4076
2BX4074
2BX4077

Typ • Type	a	b	d	e	i
2BX4 072	252	92	ø 198	ø 90	45,0
2BX4 075	220	60	ø 198	ø ISO 228-G2½	26,7
2BX4 073	285	95	ø 220	ø 102	51,0
2BX4 076	250	60	ø 280	ø ISO 228-G3	29,8
2BX4 074	338	98	ø 315	ø 125	60,0
2BX4 077	300	60	ø 315	ø ISO 228-G4	35,8

